



# ARVIND

GROUPS OF COMPANIES  
FACTORIES & BUILDINGS

Mobile : +91 9448058628 / 7760776319

Phone : 080- 41264357 / 65468427



## Arvind Peb Structure

## Arvind Cranes

## Arvind Fabricator

E- Mail : [enquirys123@gmail.com](mailto:enquirys123@gmail.com)

We build with modern technologies giving equal importance to 'Vastu'



## Arvind Construction

[www.arvindconstruction.com](http://www.arvindconstruction.com)

[www.arvindpebstructure.com](http://www.arvindpebstructure.com)

[www.arvindfabricator.com](http://www.arvindfabricator.com)

[www.arvindcranes.com](http://www.arvindcranes.com)

DESIGN  
ENGINEERING  
FABRICATIONS  
SUPPLY  
ERECTION





**ARVIND**  
GROUPS OF COMPANIES



## Providing world class Construction & Peb Structure with modern technologies giving equal importance to 'Vastu'

Introducing the latest "STATE OF ART" Technology to build high Quality, Economical & Elegant structures designed by experienced engineers. We contribute our expertise to what we build. The pre-fabricated steel structures are ideal for industrial sheds, factories, cold storage, Go-downs, Workshop, Green houses, schools / colleges, Buildings, function halls, parking shelters etc.. These structures allow free & larger surface area for optimum utilization.

We have the pleasure of introducing our company in the name and style of [www.arvindconstruction.com](http://www.arvindconstruction.com). Ours is a reputed construction company having more than 10 years of experience and we are one of the fast growing factories & building contractors in Bangalore. We are specialized in fabrication & erection of structural engineering by quality products and services in the field of civil construction and structural engineering especially in mezzanine flooring, PEB structures, crane works etc.. We are onto the process of continuous technological revolution in the field of construction having our strategy to provide world class of services to the client at affordable cost.





# PRE ENGINEERED BUILDING

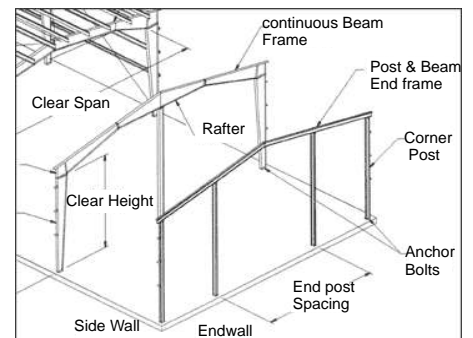
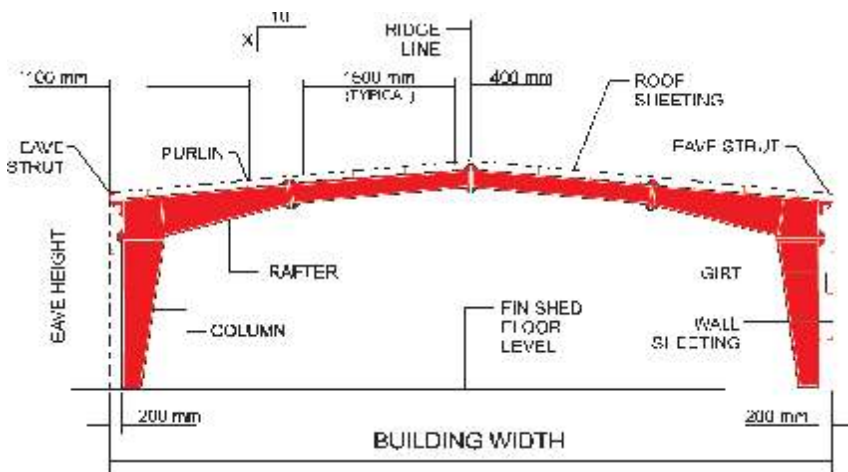
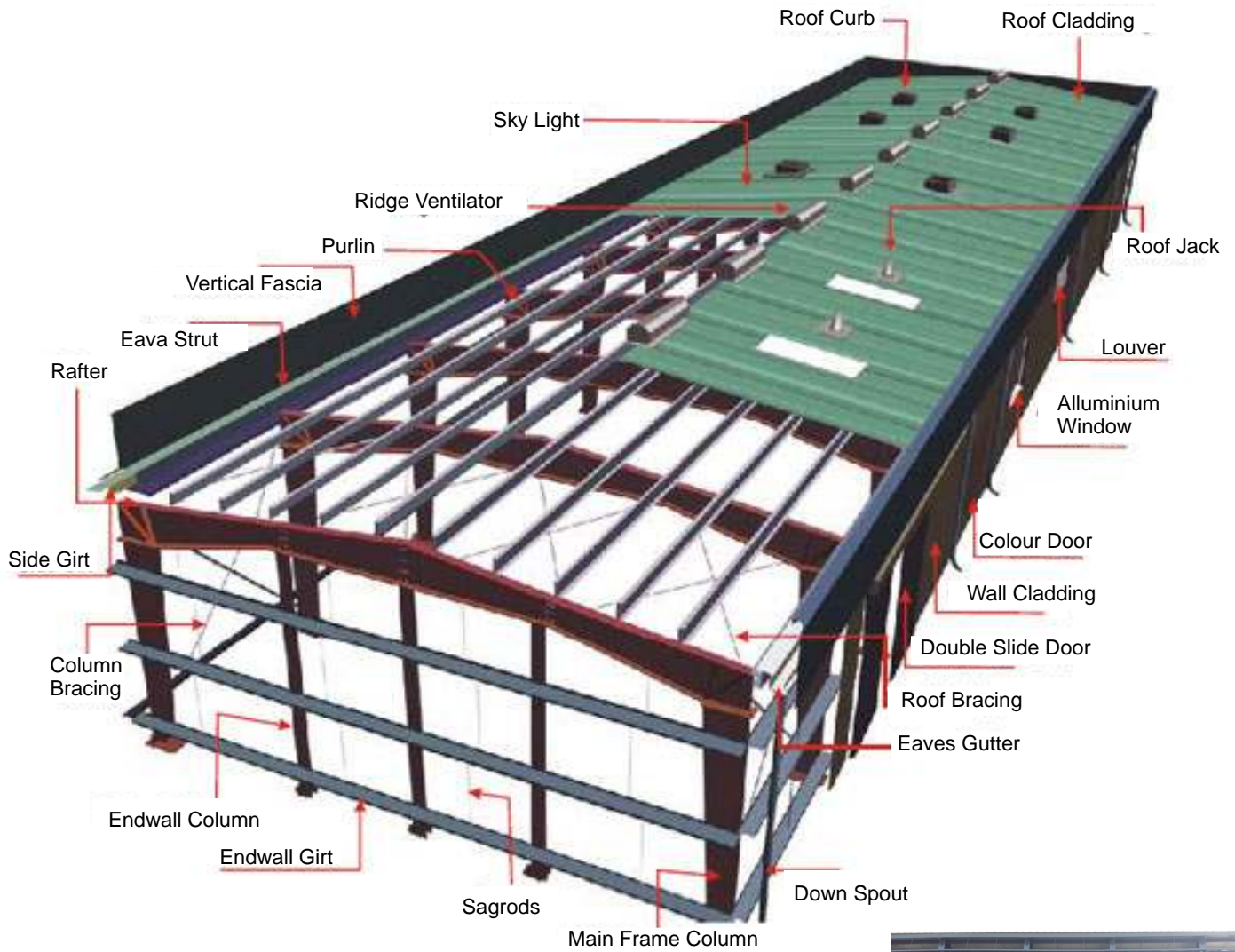

# Primary Framing Systems

Some of the most common primary framing systems are shown below.

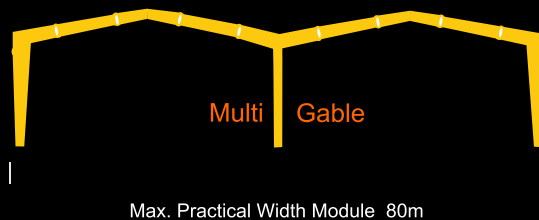
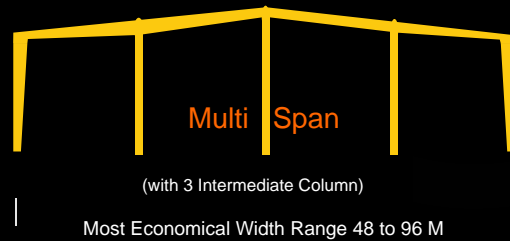
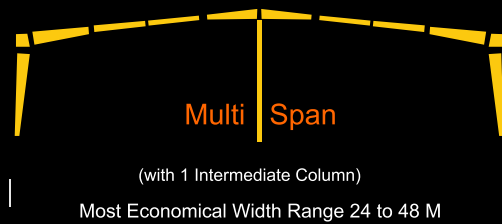
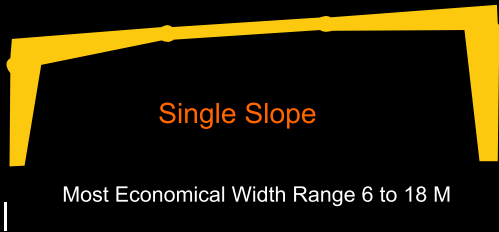
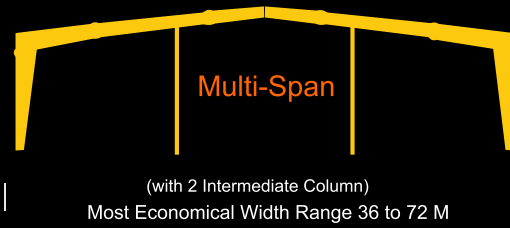

## Structural Components

### Primary Members

High Grade Steel plates with a minimum yield strength of 245 to 345 Mpa. Factory painted with a minimum of 25 Microns DFT of red oxide primer

(Minimum Yield strength is 245 to 345 Mpa.)  
Secondary Members



Typical "Z" section



Typical "C" section

Primary built-up members  
(Minimum yield strength is 245 to 345 Mpa.)



Typical Rafter



Typical Column

Secondary Members

Available in 1.5mm, 1.75mm, 2.0mm and 2.5mm thickness. High Grade Steel with a minimum yield strength of 245 to 345 Mpa. Factory painted with a minimum of 15 microns DFT of red oxide primer

# Roof & Wall Panels



ROOFING SHEET SECTIONS TYPE 1  
All dimensions are in mm.

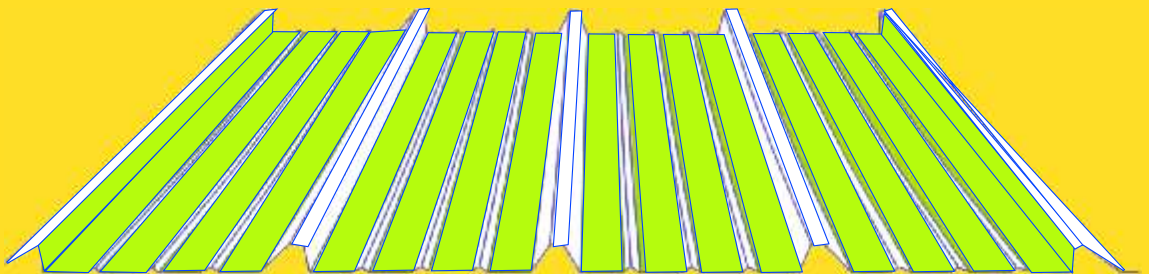
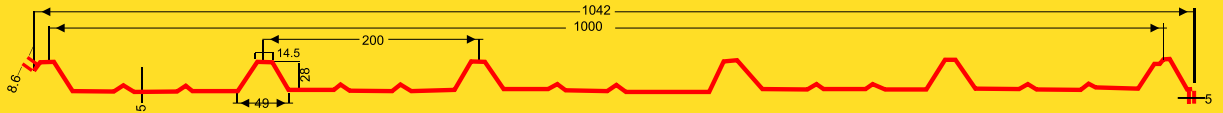

ROOFING SHEET SECTIONS TYPE 2

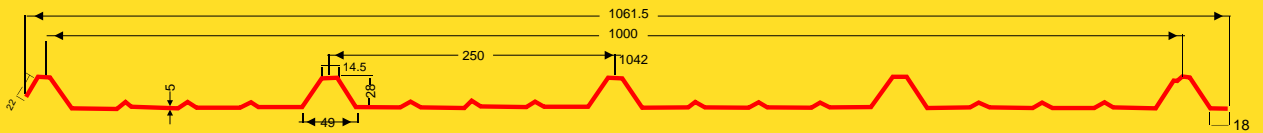

# Mazzanne Decking Sheets

Crest and 286 pitch deck panel for floor systems. This is exceptionally strong panel is used as shuttering mazzanine re-in forced concrete floor. Available thickness: 8mm, 1.2mm. Core material- Plain Galvanized.

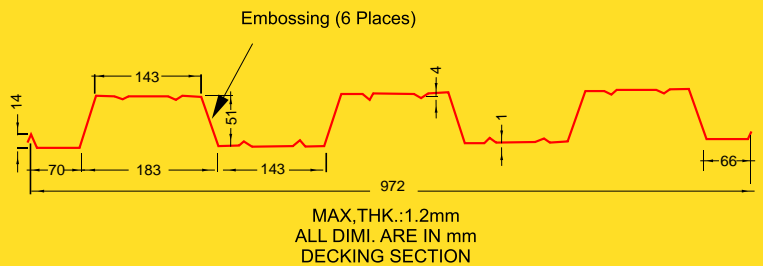

# Sandwich Puff Panels

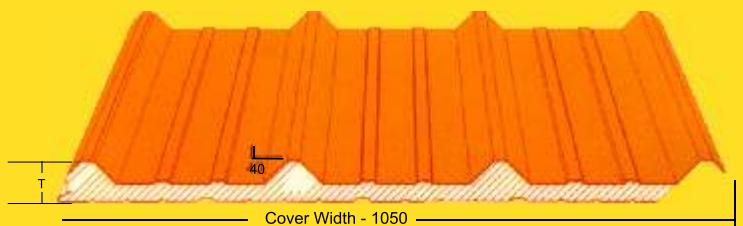

Insulation Cores Consist of Factory mode 30mm to 80mm puff insulated panel for roof application

# Strip Lighting

## The better the lighting, the better the productivity

- Rigid Polycarbonate transparent roof glazing sheets available in required lengths matching colour coated sheets, profiles made out of the finest lexan polycarbonate sheet from GE-Plastics
- FRP (fibre glass reinforced plastic) sheets required lengths thickness: 2mm, 2.5mm, 3mm



## STANDARD GUTTER, FLASHING & ACCESSORIES

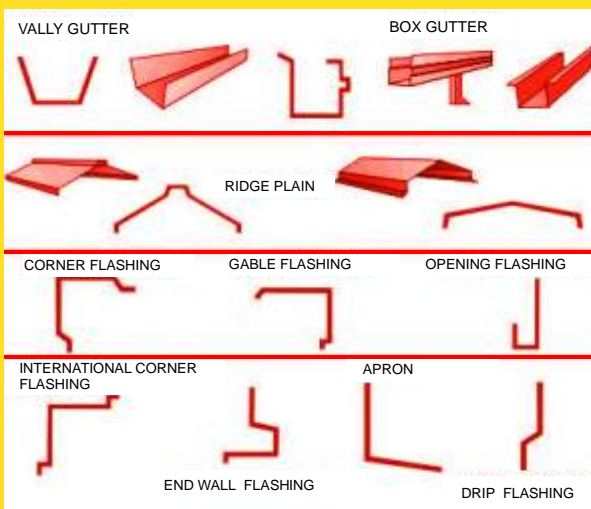

## Turbo Ventilator



We take this opportunity to introduce ourselves as a leading manufacturer of Wind Turbine Ventilators. Wind turbine ventilators are used to substitute/replace the existing powered/motorized exhaust fans. Running cost of motorized exhaust fans can be eliminated by implementing wind perated turbine ventilator which does **NOT REQUIRE MOTOR,WIRING,OPERATION OR RUNNING COST!** Turbo Ventilators provide energy free cooling and fresh air through out the year. The system functions with unlimited energy source like wind energy, saving valuable electrical energy.

## COLOUR SHADE CARDS

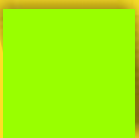

Mist Green



Cottage Green



Torres Blue

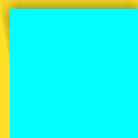

Sky Blue

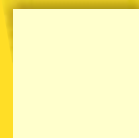

Half white



Brick red



Bare zinccalume

Actual colour may vary from those shown here and marginal variations may occur from batch to batch

## Arvind Groups of Companies

Address :

# 43, 2nd Floor, HKGN Complex  
NR Road, Near Town Hall  
Bangalore - 560 002

Mobile : +91 9448058628 / 7760776319

Phone : 080-65468427, 41264357

E- Mail : enquirys123@gamil.com

Website : [www.arvindgroups.com](http://www.arvindgroups.com)

Thank You...